

DMR™

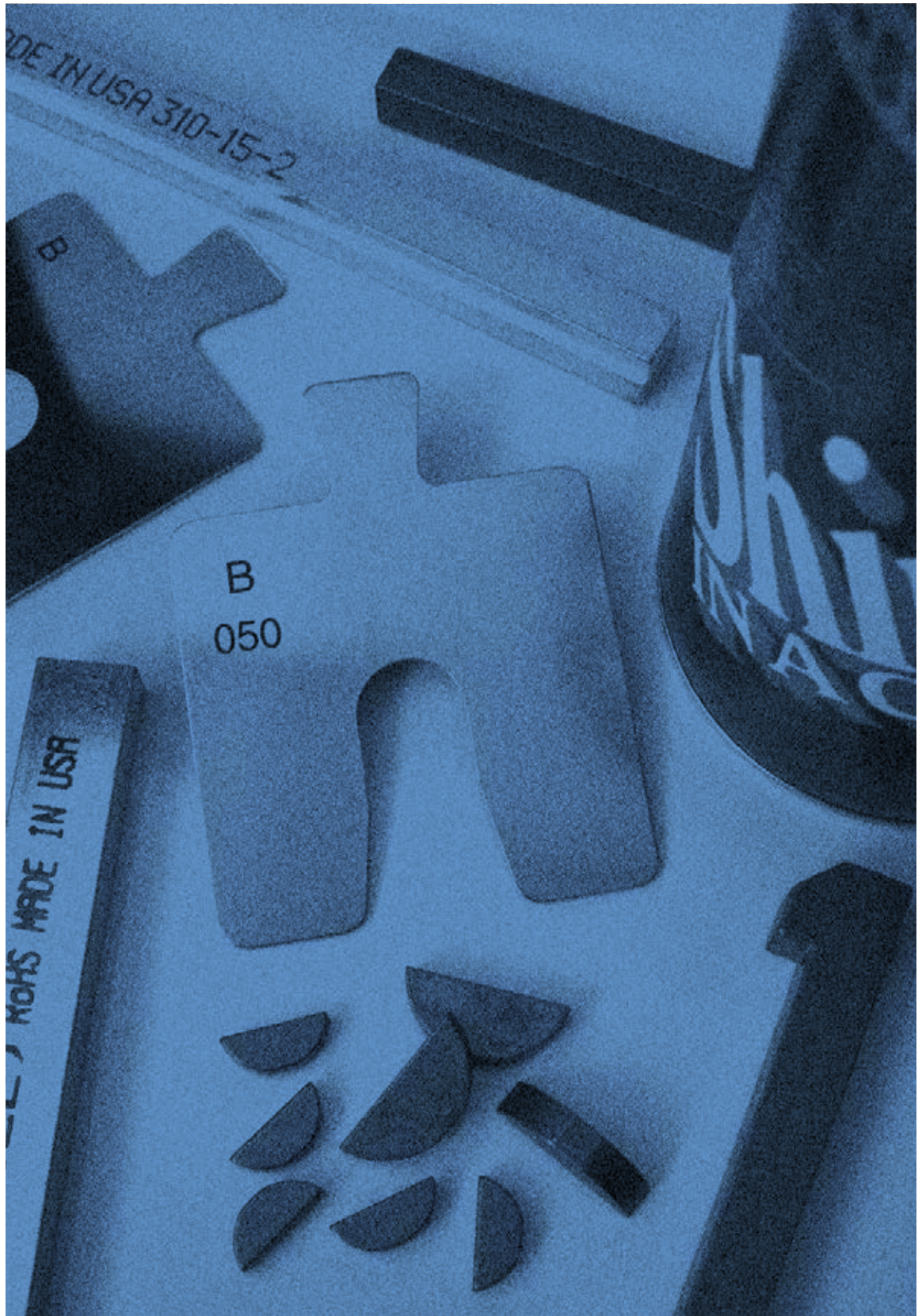

www.daemar.com



KEYSTOCK AND SHIM



For over 38 years Daemar® Inc. has remained focused on partnering with our customers to deliver precision component solutions that meet their business challenges. Whether the application is a new design or a maintenance requirement, Daemar's global partnerships offer you one of the most complete sources of supply for Keystock and Shim. To ensure that Daemar® consistently meets or exceeds customer requirements, Daemar® is ISO-9001:2008 registered and most suppliers have either TS16949-2000, QS-9000 or ISO-9001:2000 quality registrations.

Daemar® has developed all of the capabilities required to support your lean manufacturing initiatives – providing JIT delivery, vendor managed inventories and computer systems

integration. Supported by the Daemar® regional warehousing network you experience fast, courteous service throughout the world. All of Daemar's locations are fully stocked and staffed with experienced and knowledgeable sales and service professionals.

We trust that you will find this catalogue a valuable resource for selecting the appropriate Keystock and Shim for your applications. For further selection assistance, pricing and product availability please contact the Daemar® location nearest you.



| | |
|--|-------|
| Quality | 2 |
| Slotted Shim Kits..... | 3 |
| Slotted Shim Replacement Packs..... | 4-5 |
| Shim Stock Rolls | 6-9 |
| Plastic Shim..... | 10-11 |
| Square Keystock | 12-13 |
| Rectangular Keystock | 14-16 |
| Undersize Tolerance Barstock..... | 17-18 |
| Metric Keystock | 19-20 |
| Step Keystock | 21-22 |
| Standard Assortments Of Square Keystock..... | 23 |
| 3 Foot Shafts | 24 |
| Woodruff Keys..... | 25-26 |
| Woodruff Key Kits | 27 |
| Gib Head Machine Keys..... | 28-29 |
| Machinery Keys..... | 30-31 |
| Spring Pin Kits..... | 32 |

ISO-9001:2008 Registered

To consistently meet and exceed our customers' expectations, Daemar® Inc. is ISO-9001: 2008 registered and most of our suppliers are QS-9000 and/or ISO-9000 quality registered.



DMRTM
ISO 9001:2008
Registered QMS



DMR™ slotted shims are manufactured from 304 stainless steel. Each kit contains 10 (mini) or 20 (standard) shims of each thickness (.001, .002, .003, .004, .005, .010, .015, .020, .025, .050, .075, .100, .125). Let DMR™ kits provide the right solution for all of your slotted shim applications.

All shims are pad printed with thickness and size information for ease of selection

Wide slots for versatility and ease of installation

DMR™ Extended Tab for ease of installation

Sturdy steel carrying case aids in organization, storage and transport

Size A Kit

| |
|---------------------|
| Mini (OA-KIT-10) |
| Standard(OA-KIT-20) |

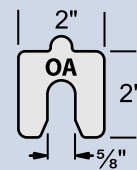

Size B Kit

| |
|---------------------|
| Mini (OB-KIT-10) |
| Standard(OB-KIT-20) |

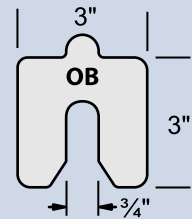

Size C Kit

| |
|---------------------|
| Mini (OC-KIT-10) |
| Standard(OC-KIT-20) |

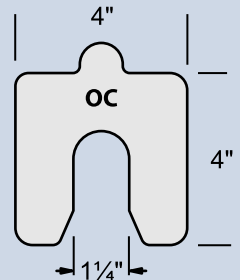

Size D Kit

| |
|---------------------|
| Mini (OD-KIT-10) |
| Standard(OD-KIT-20) |

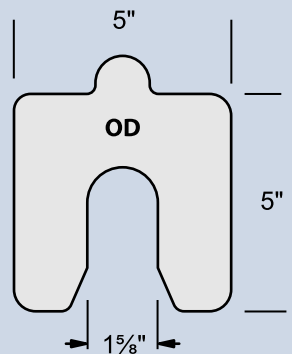

DMR slotted shim replacement kits are available in 10 piece and 20 piece packs.

| DMR # | THICKNESS | SHIM SIZE | PIECES PER PACK |
|------------|-----------|-----------|-----------------|
| .001-OA | 0.001 | 2" x 2" | 20 |
| .001-OA-10 | 0.001 | 2" x 2" | 10 |
| .002-OA | 0.002 | 2" x 2" | 20 |
| .002-OA-10 | 0.002 | 2" x 2" | 10 |
| .004-OA | 0.004 | 2" x 2" | 20 |
| .004-OA-10 | 0.004 | 2" x 2" | 10 |
| .005-OA | 0.005 | 2" x 2" | 20 |
| .005-OA-10 | 0.005 | 2" x 2" | 10 |
| .010-OA | 0.010 | 2" x 2" | 20 |
| .010-OA-10 | 0.010 | 2" x 2" | 10 |
| .015-OA | 0.015 | 2" x 2" | 20 |
| .015-OA-10 | 0.015 | 2" x 2" | 10 |
| .020-OA | 0.020 | 2" x 2" | 20 |
| .020-OA-10 | 0.020 | 2" x 2" | 10 |
| .025-OA | 0.025 | 2" x 2" | 20 |
| .025-OA-10 | 0.025 | 2" x 2" | 10 |
| .050-OA | 0.050 | 2" x 2" | 20 |
| .050-OA-10 | 0.050 | 2" x 2" | 10 |
| .075-OA | 0.075 | 2" x 2" | 20 |
| .075-OA-10 | 0.075 | 2" x 2" | 10 |
| .100-OA | 0.100 | 2" x 2" | 20 |
| .100-OA-10 | 0.100 | 2" x 2" | 10 |
| .125-OA | 0.125 | 2" x 2" | 20 |
| .125-OA-10 | 0.125 | 2" x 2" | 10 |

| DMR # | THICKNESS | SHIM SIZE | PIECES PER PACK |
|------------|-----------|-----------|-----------------|
| .001-OB | 0.001 | 3" x 3" | 20 |
| .001-OB-10 | 0.001 | 3" x 3" | 10 |
| .002-OB | 0.002 | 3" x 3" | 20 |
| .002-OB-10 | 0.002 | 3" x 3" | 10 |
| .004-OB | 0.004 | 3" x 3" | 20 |
| .004-OB-10 | 0.004 | 3" x 3" | 10 |
| .005-OB | 0.005 | 3" x 3" | 20 |
| .005-OB-10 | 0.005 | 3" x 3" | 10 |
| .010-OB | 0.010 | 3" x 3" | 20 |
| .010-OB-10 | 0.010 | 3" x 3" | 10 |
| .015-OB | 0.015 | 3" x 3" | 20 |
| .015-OB-10 | 0.015 | 3" x 3" | 10 |
| .020-OB | 0.020 | 3" x 3" | 20 |
| .020-OB-10 | 0.020 | 3" x 3" | 10 |
| .025-OB | 0.025 | 3" x 3" | 20 |
| .025-OB-10 | 0.025 | 3" x 3" | 10 |
| .050-OB | 0.050 | 3" x 3" | 20 |
| .050-OB-10 | 0.050 | 3" x 3" | 10 |
| .075-OB | 0.075 | 3" x 3" | 20 |
| .075-OB-10 | 0.075 | 3" x 3" | 10 |
| .100-OB | 0.100 | 3" x 3" | 20 |
| .100-OB-10 | 0.100 | 3" x 3" | 10 |
| .125-OB | 0.125 | 3" x 3" | 20 |
| .125-OB-10 | 0.125 | 3" x 3" | 10 |

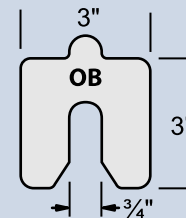
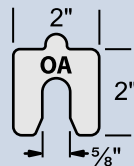

| DMR # | THICKNESS | SHIM SIZE | PIECES PER PACK |
|------------|-----------|-----------|-----------------|
| .001-OC | 0.001 | 4" x 4" | 20 |
| .001-OC-10 | 0.001 | 4" x 4" | 10 |
| .002-OC | 0.002 | 4" x 4" | 20 |
| .002-OC-10 | 0.002 | 4" x 4" | 10 |
| .004-OC | 0.004 | 4" x 4" | 20 |
| .004-OC-10 | 0.004 | 4" x 4" | 10 |
| .005-OC | 0.005 | 4" x 4" | 20 |
| .005-OC-10 | 0.005 | 4" x 4" | 10 |
| .010-OC | 0.010 | 4" x 4" | 20 |
| .010-OC-10 | 0.010 | 4" x 4" | 10 |
| .015-OC | 0.015 | 4" x 4" | 20 |
| .015-OC-10 | 0.015 | 4" x 4" | 10 |
| .020-OC | 0.020 | 4" x 4" | 20 |
| .020-OC-10 | 0.020 | 4" x 4" | 10 |
| .025-OC | 0.025 | 4" x 4" | 20 |
| .025-OC-10 | 0.025 | 4" x 4" | 10 |
| .050-OC | 0.050 | 4" x 4" | 20 |
| .050-OC-10 | 0.050 | 4" x 4" | 10 |
| .075-OC | 0.075 | 4" x 4" | 20 |
| .075-OC-10 | 0.075 | 4" x 4" | 10 |
| .100-OC | 0.100 | 4" x 4" | 20 |
| .100-OC-10 | 0.100 | 4" x 4" | 10 |
| .125-OC | 0.125 | 4" x 4" | 20 |
| .125-OC-10 | 0.125 | 4" x 4" | 10 |

| DMR # | THICKNESS | SHIM SIZE | PIECES PER PACK |
|------------|-----------|-----------|-----------------|
| .001-OD | 0.001 | 5" x 5" | 20 |
| .001-OD-10 | 0.001 | 5" x 5" | 10 |
| .002-OD | 0.002 | 5" x 5" | 20 |
| .002-OD-10 | 0.002 | 5" x 5" | 10 |
| .004-OD | 0.004 | 5" x 5" | 20 |
| .004-OD-10 | 0.004 | 5" x 5" | 10 |
| .005-OD | 0.005 | 5" x 5" | 20 |
| .005-OD-10 | 0.005 | 5" x 5" | 10 |
| .010-OD | 0.010 | 5" x 5" | 20 |
| .010-OD-10 | 0.010 | 5" x 5" | 10 |
| .015-OD | 0.015 | 5" x 5" | 20 |
| .015-OD-10 | 0.015 | 5" x 5" | 10 |
| .020-OD | 0.020 | 5" x 5" | 20 |
| .020-OD-10 | 0.020 | 5" x 5" | 10 |
| .025-OD | 0.025 | 5" x 5" | 20 |
| .025-OD-10 | 0.025 | 5" x 5" | 10 |
| .050-OD | 0.050 | 5" x 5" | 20 |
| .050-OD-10 | 0.050 | 5" x 5" | 10 |
| .075-OD | 0.075 | 5" x 5" | 20 |
| .075-OD-10 | 0.075 | 5" x 5" | 10 |
| .100-OD | 0.100 | 5" x 5" | 20 |
| .100-OD-10 | 0.100 | 5" x 5" | 10 |
| .125-OD | 0.125 | 5" x 5" | 20 |
| .125-OD-10 | 0.125 | 5" x 5" | 10 |

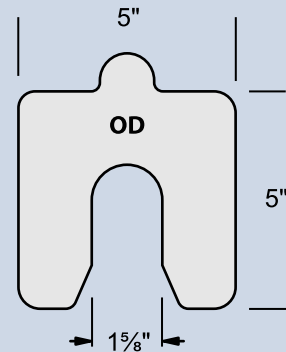
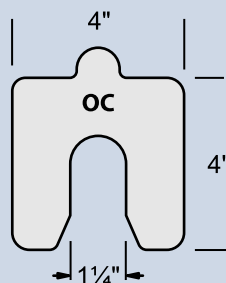

STAINLESS STEEL

DMR Stainless Steel Shim can be used in any application where corrosion is a concern. DMR Stainless Steel is 300 Series, full hard tempered (half-hard and annealed Stainless is also available on request). Full-hard Stainless Steel is slightly magnetic due to cold rolling. Stainless Steel Shim Stock has a Rockwell hardness of C40-45 and meets the following specifications: MIL-S-5059, QQS766 and QQS763. Special slit widths are also available on request. Typical weight: .010" X 6" X 50" = .875lbs.

6" X 50" ROLLS

| THICKNESS | DMR PART # |
|-----------|------------|
| .0005 | 10905-0005 |
| .001 | 10001-001 |
| .0015 | 10805-015 |
| .002 | 10002-002 |
| .003 | 10003-003 |
| .004 | 10004-004 |
| .005 | 10005-005 |
| .006 | 10006-006 |
| .007 | 10007-007 |
| .008 | 10008-008 |
| .009 | 10009-009 |
| .010 | 10010-010 |
| .012 | 10012-012 |
| .015 | 10015-015 |
| .020 | 10020-020 |
| .025 | 10025-025 |
| .031 | 10031-031 |

12" X 50" ROLLS

| THICKNESS | DMR PART # |
|-----------|------------|
| .001 | 12001-001 |
| .002 | 12002-002 |
| .003 | 12003-003 |
| .004 | 12004-004 |
| .005 | 12005-005 |
| .006 | 12006-006 |
| .007 | 12007-007 |
| .008 | 12008-008 |
| .010 | 12010-010 |
| .012 | 12012-012 |
| .015 | 12015-015 |
| .020 | 12020-020 |
| .025 | 12025-025 |
| .031 | 12031-031 |

STAINLESS STEEL SHIM TOLERANCES

| DECIMAL THICKNESS | 6" WIDTH | 12" WIDTH |
|-------------------|-----------|-----------|
| .0005-.010 | +/- 10% | +/- 10% |
| .011 - .019 | +/- .001 | +/- .0015 |
| .020 -.028 | +/- .0015 | +/- .0015 |
| .029 - .031 | +/- .002 | +/- .002 |
| Width Tolerance | +/- .005 | +/- .010 |

BRASS

DMR Brass Shim Stock is used where some stiffness is required and where corrosion problems exist. It has been cold rolled to a 1/2 hard temper with a tensile strength of approx. 62,000 PSI. Brass Shim Stock is 70% Copper & 30% Zinc. It has a Rockwell hardness of 30T 56/68.

Brass Shim Stock meets the following specifications: SAE-CA 260, ASTM-B-36, AMS-4507 & QQB-613-#2. Typical weight : .010" X 6" X 100" 1.8 lbs.



6" X 100" ROLLS

| THICKNESS | DMR PART # |
|-----------|------------|
| .001 | 20001-001 |
| .0015 | 20805-015 |
| .002 | 20002-002 |
| .003 | 20003-003 |
| .004 | 20004-004 |
| .005 | 20005-005 |
| .006 | 20006-006 |
| .007 | 20007-007 |
| .008 | 20008-008 |
| .009 | 20009-009 |
| .010 | 20010-010 |
| .012 | 20012-012 |
| .015 | 20015-015 |
| .020 | 20020-020 |
| .025 | 20025-025 |
| .031 | 20031-031 |

12" X 120" ROLLS

| THICKNESS | DMR PART # |
|-----------|------------|
| .001 | 22001-001 |
| .002 | 22002-002 |
| .003 | 22003-003 |
| .004 | 22004-004 |
| .005 | 22005-005 |
| .006 | 22006-006 |
| .008 | 22008-008 |
| .010 | 22010-010 |

STEEL SHIM TOLERANCES

| DECIMAL THICKNESS | 6" WIDTH | 12" WIDTH |
|-------------------|-----------|-----------|
| .001-.003 | +/- 10% | +/- 10% |
| .004 | +/- .0003 | +/- .0006 |
| .005 - .006 | +/- .0004 | +/- .0008 |
| .007-.009 | +/- .0006 | +/- .0010 |
| .010 - .013 | +/- .0008 | +/- .0013 |
| .014 - .017 | +/- .0010 | +/- .0015 |
| .018 - .021 | +/- .0013 | +/- .0018 |
| .022 - .031 | +/- .002 | +/- .002 |
| Width Tolerance | +/- .008 | +/- .008 |

STEEL SHIM STOCK

DMR Steel Shim is low carbon mild steel cold rolled to a #1 hard temper. It is stiff and springy, and can be used where hardness is required. The material can be punched or sheared with minimum burring and distortion. Steel Shim Stock meets the following specifications: AISI 1010 & QQS 698. Available in .001" to .031" and in standard packages 6" X 100" or 12" X 120". Special slit widths are also available on request. Typical weight .010" X 6" X 100" = 1.7lbs.

6" X 100" ROLLS

| THICKNESS | DMR PART # |
|-----------|------------|
| .001 | 30001-001 |
| .0015 | 30805-015 |
| .002 | 30002-002 |
| .003 | 30003-003 |
| .004 | 30004-004 |
| .005 | 30005-005 |
| .006 | 30006-006 |
| .007 | 30007-007 |
| .008 | 30008-008 |
| .009 | 30009-009 |
| .010 | 30010-010 |
| .012 | 30012-012 |
| .015 | 30015-015 |
| .020 | 30020-020 |
| .025 | 30025-025 |
| .031 | 30031-031 |

12" X 120" ROLLS

| THICKNESS | DMR PART # |
|-----------|------------|
| .001 | 32001-001 |
| .002 | 32002-002 |
| .003 | 32003-003 |
| .004 | 32004-004 |
| .005 | 32005-005 |
| .006 | 32006-006 |
| .007 | 32007-007 |
| .008 | 32008-008 |
| .009 | 32009-009 |
| .010 | 32010-010 |
| .012 | 32012-012 |
| .015 | 32015-015 |
| .018 | 32018-018 |
| .020 | 32020-020 |
| .025 | 32025-025 |
| .031 | 32031-031 |

STEEL SHIM TOLERANCES

| Decimal Thickness | 6" Width | 12" Width |
|------------------------|-----------------|-----------------|
| .001-.003 | +/- 10% | +/- 10% |
| .0035 - .006 | +/- .005 | +/- .005 |
| .007 - .018 | +/- .00075 | +/- .00075 |
| .020 -.025 | +/- .001 | +/- .001 |
| .031 | +/- .0015 | +/- .0015 |
| Width Tolerance | +/- .005 | +/- .010 |

NICKEL

DMR Nickel Shim Stock is a 200 grade annealed material. It meets the following specifications: ASTM-B-160, B161, B162, B163 & B366. Nickel shim is available in thickness from .001" to .010" and in standard packages of 6" X 50". Special slit widths are also available on request. Typical weight: .010" X 6" X 50' = .48 lbs.

ALUMINUM

DMR Aluminum Shim Stock is a type 1100, which has a minimum aluminum content of 99%. Its temper is H-18, full hard. Aluminum shim stock has excellent corrosion resistance and high thermal and electrical conductivity. The material meets the following specifications: QQA 250, MIL-W-85, ASTM-B-209. Aluminum shim is available in thicknesses from .001" to .010" and in standard packages of 6" x 100". Special slit widths are available on request. Typical weight: .010" x 6" x 100" = .57 lbs.

ALUMINUM SHIM TOLERANCES

| DECIMAL THICKNESS | TOLERANCE |
|-------------------|-----------|
| .001-.010 | +/- 5% |
| Width Tolerance | +/- .0625 |

BLUE TEMPERED

DMR Blue Tempered Shim Stock is 1095 high carbon spring steel. It has a Rockwell hardness of C 48/51. Blue Tempered Spring Steel is polished and blued. Blue Tempered Spring Steel shim is available in thicknesses from .002" to .032", 6" x 25". Special slit widths are available on request. Typical weight: .010" x 6" x 50" = .88 lbs.

BLUE TEMPERED TOLERANCES

| DECIMAL THICKNESS | 3" TO 6" WIDTHS |
|-------------------|-----------------|
| .002 - .004 | +/- .0005 |
| .010 - .013 | +/- .001 |
| .020 - .032 | +/- .002 |
| Width Tolerance | +/- .005 |

ANNEALED STEEL

DMR Annealed Steel is 1075 high-Carbon steel, which is heat treatable. Annealed Steel is a spheroidized annealed temper. DMR Annealed Shim Stock is the only shim that can be formed in its annealed condition, and then heat-treated to a hard (spring) temper. Special slit widths upon request. Typical weight: .032" x 6" x 50" = 2.5lbs.

COPPER

DMR Copper Shim Stock is a 110 alloy material in the annealed (soft) condition. Copper shim meets the following specifications; CDA-110, MIL-C12168, QQC-576. Copper shim is available in thicknesses from .001" to .010" in standard packages 6" x 100" cans. Special slit widths are available on request. Typical weight: .010" x 6" x 100" = 1.94lbs.

COPPER SHIM TOLERANCES

| DECIMAL THICKNESS | TOLERANCE |
|-------------------|-----------|
| .001 - .003 | +/- .0003 |
| .004 - .007 | +/- .0004 |
| .008 - .010 | +/- .0005 |
| Width Tolerance | +/- .005 |

DMR Plastic Shim Stock is colour coded for your convenience. It is used where corrosion is a problem. The size of the pieces are 5" x 20", 10" x 20", 20" x 20". From .0005" to .030" Special slit widths are available on request.

| DMR # | COLOUR | THICKNESS | SHEET SIZE | PIECES PER PACK |
|------------|--------|-----------|------------|-----------------|
| 80901-0005 | SILVER | 0.0005 | 5" x 20" | 20 |
| 80902-001 | AMBER | 0.001 | 5" x 20" | 20 |
| 80903-0015 | PURPLE | 0.0015 | 5" x 20" | 20 |
| 80904-002 | RED | 0.002 | 5" x 20" | 20 |
| 80905-003 | GREEN | 0.003 | 5" x 20" | 20 |
| 80906-004 | TAN | 0.004 | 5" x 20" | 20 |
| 80907-005 | BLUE | 0.005 | 5" x 20" | 20 |
| 80908-0075 | MATTE | 0.0075 | 5" x 20" | 20 |
| 80909-010 | BROWN | 0.010 | 5" x 20" | 20 |
| 80910-125 | BLACK | 0.0125 | 5" x 20" | 20 |
| 80911-015 | PINK | 0.015 | 5" x 20" | 20 |
| 80912-020 | YELLOW | 0.020 | 5" x 20" | 20 |
| 80913-025 | WHITE | 0.025 | 5" x 20" | 20 |
| 80914-030 | CORAL | 0.030 | 5" x 20" | 20 |
| 80915-040 | CLEAR | 0.040 | 5" x 20" | 10 |
| 80916-050 | CLEAR | 0.050 | 5" x 20" | 10 |
| 80917-060 | CLEAR | 0.060 | 5" x 20" | 10 |

| DMR # | COLOUR | THICKNESS | SHEET SIZE | PIECES PER PACK |
|------------|--------|-----------|------------|-----------------|
| 80001-0005 | SILVER | 0.0005 | 10" x 20" | 20 |
| 80002-001 | AMBER | 0.001 | 10" x 20" | 20 |
| 80003-0015 | PURPLE | 0.0015 | 10" x 20" | 20 |
| 80004-002 | RED | 0.002 | 10" x 20" | 20 |
| 80005-003 | GREEN | 0.003 | 10" x 20" | 20 |
| 80006-004 | TAN | 0.004 | 10" x 20" | 20 |
| 80007-005 | BLUE | 0.005 | 10" x 20" | 20 |
| 80008-0075 | MATTE | 0.0075 | 10" x 20" | 20 |
| 80009-010 | BROWN | 0.010 | 10" x 20" | 20 |
| 80010-125 | BLACK | 0.0125 | 10" x 20" | 20 |
| 80011-015 | PINK | 0.015 | 10" x 20" | 20 |
| 80012-020 | YELLOW | 0.020 | 10" x 20" | 20 |

| DMR # | COLOUR | THICKNESS | SHEET SIZE | PIECES PER PACK |
|-----------|--------|-----------|------------|-----------------|
| 80013-025 | WHITE | 0.025 | 10" x 20" | 20 |
| 80014-030 | CORAL | 0.030 | 10" x 20" | 20 |
| 80015-040 | CLEAR | 0.040 | 10" x 20" | 10 |
| 80016-050 | CLEAR | 0.050 | 10" x 20" | 10 |
| 80017-060 | CLEAR | 0.060 | 10" x 20" | 10 |

| DMR # | COLOUR | THICKNESS | SHEET SIZE | PIECES PER PACK |
|------------|--------|-----------|------------|-----------------|
| 80118-0005 | SILVER | 0.0005 | 20" x 20" | 10 |
| 80119-001 | AMBER | 0.001 | 20" x 20" | 10 |
| 80120-0015 | PURPLE | 0.0015 | 20" x 20" | 10 |
| 80121-002 | RED | 0.002 | 20" x 20" | 10 |
| 80122-003 | GREEN | 0.003 | 20" x 20" | 10 |
| 80123-004 | TAN | 0.004 | 20" x 20" | 10 |
| 80124-005 | BLUE | 0.005 | 20" x 20" | 10 |
| 80125-0075 | MATTE | 0.0075 | 20" x 20" | 10 |
| 80126-010 | BROWN | 0.010 | 20" x 20" | 10 |
| 80127-125 | BLACK | 0.0125 | 20" x 20" | 10 |
| 80128-015 | PINK | 0.015 | 20" x 20" | 10 |
| 80129-020 | YELLOW | 0.020 | 20" x 20" | 10 |
| 80130-025 | WHITE | 0.025 | 20" x 20" | 10 |
| 80131-030 | CORAL | 0.030 | 20" x 20" | 10 |
| 80132-040 | CLEAR | 0.040 | 20" x 20" | 10 |
| 80133-050 | CLEAR | 0.050 | 20" x 20" | 10 |
| 80134-060 | CLEAR | 0.060 | 20" x 20" | 10 |

| DMR# | SHEET SIZE | TOTAL # OF PIECES | THICKNESSES (ONE PIECE OF EACH THICKNESS) |
|--------------|------------|-------------------|--|
| 80018-ASSORT | 5" x 20" | 14 | 0.0005", 0.001", 0.0015", 0.002", 0.003", 0.004", 0.005", 0.0075", 0.010", 0.0125", 0.015", 0.020", 0.025", 0.030" |
| 80036-ASSORT | 10" x 20" | 14 | 0.0005", 0.001", 0.0015", 0.002", 0.003", 0.004", 0.005", 0.0075", 0.010", 0.0125", 0.015", 0.020", 0.025", 0.030" |
| 80055-ASSORT | 20" x 20" | 14 | 0.0005", 0.001", 0.0015", 0.002", 0.003", 0.004", 0.005", 0.0075", 0.010", 0.0125", 0.015", 0.020", 0.025", 0.030" |

All DMR™ steel keystock is available in 12" and 36" lengths with the size clearly marked on each bar. The material is 1018 carbon steel and is available with either zinc plated or plain finish, stainless and brass.

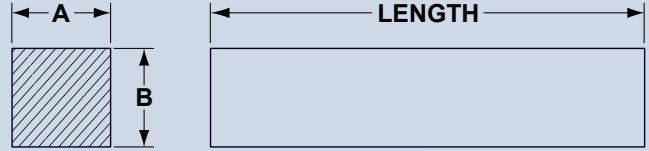

TOLERANCES

| SIZE | SQUARES | | FLATS | |
|------------------|--------------------|--------------------|--------------------|--------------------|
| | ZINC PLATED | PLAIN FINISH | ZINC PLATED | PLAIN FINISH |
| 3/4" and smaller | + .003 to -.000 | + .002 to -.000 | + .004 to -.000 | + .003 to -.000 |
| 7/8 THRU 1-1/2" | + .004 to -.000 | + .003 to -.000 | + .005 to -.000 | + .004 to -.000 |
| 1-5/8" THRU 2" | + .005 to -.000 | + .004 to -.000 | + .006 to -.000 | + .005 to -.000 |

| SIZE A&B | DMR™ PART # 12" LENGTH | DMR™ PART # 12" LENGTH UNPLATED | WT. PER PIECE | DMR™ PART # 36" LENGTH | DMR™ PART # 36" LENGTH UNPLATED | WT. PER PIECE |
|--------------|------------------------------|---------------------------------------|------------------|---------------------------|---------------------------------------|------------------|
| 1/16" Square | 0.063-12 | 0.063-12-U | 0.013 | 0.063-36 | 0.063-36-U | .040 |
| 3/32" Square | 0.093-12 | 0.093-12-U | 0.030 | 0.093-36 | 0.093-36-U | 0.089 |
| 1/8" Square | 0.125-12 | 0.125-12-U | 0.053 | 0.125-36 | 0.125-36-U | 0.160 |
| 5/32" Square | 0.156-12 | 0.156-12-U | 0.083 | 0.156-36 | 0.156-36-U | 0.249 |
| 3/16" Square | 0.188-12 | 0.188-12-U | 0.120 | 0.188-36 | 0.188-36-U | 0.360 |
| 7/32" Square | 0.219-12 | 0.219-12-U | 0.163 | 0.219-36 | 0.219-36-U | 0.489 |
| 1/4" Square | 0.250-12 | 0.250-12-U | 0.213 | 0.250-36 | 0.250-36-U | 0.639 |
| 9/32" Square | 0.281-12 | 0.281-12-U | 0.269 | 0.281-36 | 0.281-36-U | 0.807 |
| 5/16" Square | 0.313-12 | 0.313-12-U | 0.332 | 0.313-36 | 0.313-36-U | 0.996 |
| 3/8" Square | 0.375-12 | 0.375-12-U | 0.478 | 0.375-36 | 0.375-36-U | 1.434 |
| 7/16" Square | 0.438-12 | 0.438-12-U | 0.651 | 0.438-36 | 0.438-36-U | 1.953 |
| 1/2" Square | 0.500-12 | 0.500-12-U | 0.850 | 0.500-36 | 0.500-36-U | 2.550 |
| 9/16" Square | 0.563-12 | 0.563-12-U | 1.076 | 0.563-36 | 0.563-36-U | 3.228 |
| 5/8" Square | 0.625-12 | 0.625-12-U | 1.329 | 0.625-36 | 0.625-36-U | 3.987 |

| SIZE A&B | DMR™ PART # 12" LENGTH | DMR™ PART # 12" LENGTH UNPLATED | WT. PER PIECE | DMR™ PART # 36" LENGTH | DMR™ PART # 36" LENGTH UNPLATED | WT. PER PIECE |
|----------------|---------------------------|---------------------------------------|------------------|---------------------------|---------------------------------------|------------------|
| 11/16" Square | 0.688-12 | 0.688-12-U | 1.608 | 0.688-36 | 0.688-36-U | 4.824 |
| 3/4" Square | 0.750-12 | 0.750-12-U | 1.914 | 0.750-36 | 0.750-36-U | 5.742 |
| 13/16" Square | 0.813-12 | 0.813-12-U | 2.246 | 0.813-36 | 0.813-36-U | 6.738 |
| 7/8" Square | 0.875-12 | 0.875-12-U | 2.605 | 0.875-36 | 0.875-36-U | 7.815 |
| 15/16" Square | 0.938-12 | 0.938-12-U | 2.990 | 0.938-36 | 0.938-36-U | 8.970 |
| 1" Square | 1.000-12 | 1.000-12-U | 3.402 | 1.000-36 | 1.000-36-U | 10.206 |
| 1-1/6" Square | 1.063-12 | 1.063-12-U | 3.831 | 1.063-36 | 1.063-36-U | 11.493 |
| 1-1/8" Square | 1.125-12 | 1.125-12-U | 4.306 | 1.125-36 | 1.125-36-U | 12.918 |
| 1-3/16" Square | 1.188-12 | 1.188-12-U | 4.798 | 1.188-36 | 1.188-36-U | 14.637 |
| 1-1/4" Square | 1.250-12 | 1.250-12-U | 5.316 | 1.250-36 | 1.250-36-U | 15.948 |
| 1-5/16" Square | 1.312-12 | 1.312-12-U | 5.875 | 1.312-36 | 1.312-36-U | 17.625 |
| 1-3/8" Square | 1.375-12 | 1.375-12-U | 6.432 | 1.375-36 | 1.375-36-U | 19.296 |
| 1-7/16" Square | 1.438-12 | 1.438-12-U | 7.026 | 1.438-36 | 1.438-36-U | 21.078 |
| 1-1/2" Square | 1.500-12 | 1.500-12-U | 7.665 | 1.500-36 | 1.500-36-U | 22.990 |
| 1-5/8" Square | 1.625-12 | 1.625-12-U | 8.984 | 1.625-36 | 1.625-36-U | 26.950 |
| 1-3/4" Square | 1.750-12 | 1.750-12-U | 10.419 | 1.750-36 | 1.750-36-U | 31.257 |
| 1-7/8" Square | 1.875-12 | 1.875-12-U | 11.950 | 1.875-36 | 1.875-36-U | 35.850 |
| 2" Square | 2.000-12 | 2.000-12-U | 13.600 | 2.000-36 | 2.000-36-U | 40.800 |
| 2-1/4" Square | 2.250-12 | 2.250-12-U | 17.230 | 2.250-36 | 2.250-36-U | 51.690 |
| 2-1/2" Square | 2.500-12 | 2.500-12-U | 21.270 | 2.500-36 | 2.500-36-U | 63.810 |

All DMR™ steel keystock is available in 12" and 36" lengths with the size clearly marked on each bar. The material is 1018 carbon steel and is available with either zinc plated or plain finish, stainless and brass.

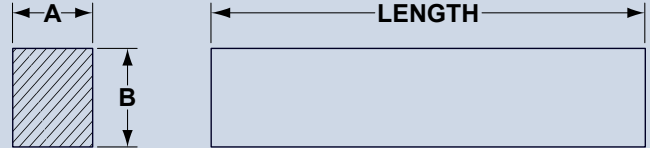

| A | B | DMR™ PART # 12" LENGTH | DMR™ PART # 12" LENGTH UNPLATED | WT. PER PIECE | DMR™ PART # 36" LENGTH | DMR™ PART # 36" LENGTH UNPLATED | WT. PER PIECE |
|-------|-------|---------------------------------|--|------------------|---------------------------------|--|------------------|
| 1/8" | 3/16" | 0.125-188-12 | 0.125-188-12-U | 0.080 | 0.125-188-36 | 0.125-188-36-U | 0.240 |
| 1/8" | 1/4" | 0.125-250-12 | 0.125-250-12-U | 0.106 | 0.125-250-36 | 0.125-250-36-U | 0.318 |
| 1/8" | 3/8" | 0.125-375-12 | 0.125-375-12-U | 0.159 | 0.125-375-36 | 0.125-375-36-U | 0.477 |
| 1/8" | 1/2" | 0.125-500-12 | 0.125-500-12-U | 0.213 | 0.125-500-36 | 0.125-500-36-U | 0.639 |
| 1/8" | 5/8" | 0.125-625-12 | 0.125-625-12-U | 0.266 | 0.125-625-36 | 0.125-625-36-U | 0.798 |
| 1/8" | 3/4" | 0.125-750-12 | 0.125-750-12-U | 0.319 | 0.125-750-36 | 0.125-750-36-U | 0.945 |
| 3/16" | 1/4" | 0.188-250-12 | 0.188-250-12-U | 0.159 | 0.188-250-36 | 0.188-250-36-U | 0.477 |
| 3/16" | 5/16" | 0.188-313-12 | 0.188-313-12-U | 0.199 | 0.188-313-36 | 0.188-313-36-U | 0.598 |
| 3/16" | 3/8" | 0.188-375-12 | 0.188-375-12-U | 0.239 | 0.188-375-36 | 0.188-375-36-U | 0.717 |
| 3/16" | 7/16" | 0.188-438-12 | 0.188-438-12-U | 0.279 | 0.188-438-36 | 0.188-438-36-U | 0.892 |
| 3/16" | 1/2" | 0.188-500-12 | 0.188-500-12-U | 0.319 | 0.188-500-36 | 0.188-500-36 | 0.957 |
| 3/16" | 5/8" | 0.188-625-12 | 0.188-625-12-U | 0.398 | 0.188-625-36 | 0.188-625-36 | 1.196 |
| 3/16" | 7/8" | 0.188-875-12 | 0.188-875-12-U | 0.558 | 0.188-875-36 | 0.188-875-36 | 1.674 |
| 1/4" | 5/16" | 0.250-313-12 | 0.250-313-12-U | 0.266 | 0.250-313-36 | 0.250-313-36-U | 0.798 |
| 1/4" | 3/8" | 0.250-375-12 | 0.250-375-12-U | 0.319 | 0.250-375-36 | 0.250-375-36-U | 4.785 |
| 1/4" | 7/16" | 0.250-438-12 | 0.250-438-12-U | 0.372 | 0.250-438-36 | 0.250-438-36-U | 1.117 |
| 1/4" | 1/2" | 0.250-500-12 | 0.250-500-12-U | 0.425 | 0.250-500-36 | 0.250-500-36-U | 1.275 |
| 1/4" | 9/16" | 0.250-563-12 | 0.250-563-12-U | 0.478 | 0.250-563-36 | 0.250-563-36-U | 1.436 |
| 1/4" | 5/8" | 0.250-625-12 | 0.250-625-12-U | 0.531 | 0.250-625-36 | 0.250-625-36-U | 1.593 |
| 1/4" | 3/4" | 0.250-750-12 | 0.250-750-12-U | 0.638 | 0.250-750-36 | 0.250-750-36-U | 1.914 |
| 5/16" | 3/8" | 0.313-375-12 | 0.313-375-12-U | 0.398 | 0.313-375-36 | 0.313-375-36-U | 1.194 |
| 5/16" | 7/16" | 0.313-438-12 | 0.313-438-12-U | 0.465 | 0.313-438-36 | 0.313-438-36-U | 1.395 |
| 5/16" | 1/2" | 0.313-500-12 | 0.313-500-12-U | 0.533 | 0.313-500-36 | 0.313-500-36-U | 1.593 |
| 5/16" | 9/16" | 0.313-563-12 | 0.313-563-12-U | 0.598 | 0.313-563-36 | 0.313-563-36-U | 1.795 |
| 5/16" | 5/8" | 0.313-625-12 | 0.313-625-12-U | 0.664 | 0.313-625-36 | 0.313-625-36-U | 1.994 |

| A | B | DMR™ PART # 12" LENGTH | DMR™ PART # 12" LENGTH UNPLATED | WT. PER PIECE | DMR™ PART # 36" LENGTH | DMR™ PART # 36" LENGTH UNPLATED | WT. PER PIECE |
|--------|---------|---------------------------------|--|------------------|---------------------------------|--|------------------|
| 5/16" | 3/4" | 0.313-750-12 | 0.313-750-12-U | 0.797 | 0.313-750-36 | 0.313-750-36-U | 2.393 |
| 3/8" | 7/16" | 0.375-438-12 | 0.375-438-12-U | 0.930 | 0.375-438-36 | 0.375-438-36-U | 1.675 |
| 3/8" | 9/16" | 0.375-563-12 | 0.375-563-12-U | 0.717 | 0.375-563-36 | 0.375-563-36-U | 2.153 |
| 3/8" | 5/8" | 0.375-625-12 | 0.375-625-12-U | 0.797 | 0.375-625-36 | 0.375-625-36-U | 2.393 |
| 3/8" | 3/4" | 0.375-750-12 | 0.375-750-12-U | 0.956 | 0.375-750-36 | 0.375-750-36-U | 2.868 |
| 3/8" | 1" | 0.375-1000-12 | 0.375-1000-12-U | 1.275 | 0.375-1000-36 | 0.375-1000-36-U | 3.828 |
| 7/16" | 1/2" | 0.438-500-12 | 0.438-500-12-U | 0.744 | 0.438-500-36 | 0.438-500-36-U | 2.232 |
| 7/16" | 9/16" | 0.438-563-12 | 0.438-563-12-U | 0.837 | 0.438-563-36 | 0.438-563-36-U | 2.513 |
| 7/16" | 5/8" | 0.438-625-12 | 0.438-625-12-U | 0.930 | 0.438-625-36 | 0.438-625-36-U | 2.790 |
| 7/16" | 3/4" | 0.438-750-12 | 0.438-750-12-U | 1.116 | 0.438-750-36 | 0.438-750-36-U | 3.351 |
| 1/2" | 9/16" | 0.500-563-12 | 0.500-563-12-U | 0.956 | 0.500-563-36 | 0.500-563-36-U | 2.550 |
| 1/2" | 5/8" | 0.500-625-12 | 0.500-625-12-U | 1.063 | 0.500-625-36 | 0.500-625-36-U | 2.872 |
| 1/2" | 11/16" | 0.500-688-12 | 0.500-688-12-U | 1.169 | 0.500-688-36 | 0.500-688-36-U | 3.507 |
| 1/2" | 3/4" | 0.500-750-12 | 0.500-750-12-U | 1.275 | 0.500-750-36 | 0.500-750-36-U | 3.825 |
| 1/2" | 7/8" | 0.500-875-12 | 0.500-875-12-U | 1.486 | 0.500-875-36 | 0.500-875-36-U | 4.458 |
| 1/2" | 1" | 0.500-1000-12 | 0.500-1000-12-U | 1.700 | 0.500-1000-36 | 0.500-1000-36-U | 5.100 |
| 9/16" | 5/8" | 0.563-625-12 | 0.563-625-12-U | 1.200 | 0.563-625-36 | 0.563-625-36-U | 3.600 |
| 9/16" | 3/4" | 0.563-750-12 | 0.563-750-12-U | 1.430 | 0.563-750-36 | 0.563-750-36-U | 4.290 |
| 9/16" | 1" | 0.563-1000-12 | 0.563-1000-12-U | 1.910 | 0.563-1000-36 | 0.563-1000-36-U | 5.730 |
| 9/16" | 1-1/14" | 0.563-1250-12 | 0.563-1250-12-U | 2.390 | 0.563-1250-36 | 0.563-1250-36-U | 7.179 |
| 5/8" | 1/16" | 0.625-688-12 | 0.625-688-12-U | 1.460 | 0.625-688-36 | 0.625-688-36-U | 4.380 |
| 5/8" | 3/4" | 0.625-750-12 | 0.625-750-12-U | 1.590 | 0.625-750-36 | 0.625-750-36-U | 4.770 |
| 5/8" | 7/8" | 0.625-875-12 | 0.625-875-12-U | 1.860 | 0.625-875-36 | 0.625-875-36-U | 5.580 |
| 5/8" | 1" | 0.625-1000-12 | 0.625-1000-12-U | 2.130 | 0.625-1000-36 | 0.625-1000-36-U | 2.130 |
| 5/8" | 1-1/4" | 0.625-1250-12 | 0.625-1250-12-U | 2.660 | 0.625-1250-36 | 0.625-1250-36-U | 7.977 |
| 11/16" | 3/4" | 0.688-750-12 | 0.688-750-12-U | 1.750 | 0.688-750-36 | 0.688-750-36-U | 5.250 |
| 11/16" | 7/8" | 0.688-875-12 | 0.688-875-12-U | 2.050 | 0.688-875-36 | 0.688-875-36-U | 6.150 |
| 11/16" | 1" | 0.688-1000-12 | 0.688-1000-12-U | 2.340 | 0.688-1000-36 | 0.688-1000-36-U | 7.020 |
| 3/4" | 7/8" | 0.750-875-12 | 0.750-875-12-U | 2.230 | 0.750-875-36 | 0.750-875-36-U | 6.690 |

| A | B | DMR™ PART # 12" LENGTH | DMR™ PART # 12" LENGTH UNPLATED | WT. PER PIECE | DMR™ PART # 36" LENGTH | DMR™ PART # 36" LENGTH UNPLATED | WT. PER PIECE |
|--------|--------|---------------------------------|--|------------------|---------------------------------|--|------------------|
| 3/4" | 1" | 0.750-1000-12 | 0.750-1000-12-U | 2.550 | 0.750-1000-36 | 0.750-1000-36-U | 7.650 |
| 3/4" | 1-1/8" | 0.750-1125-12 | 0.750-1125-12-U | 2.870 | 0.750-1125-36 | 0.750-1125-36-U | 8.610 |
| 3/4" | 1-1/2" | 0.750-1500-12 | 0.750-1500-12-U | 3.830 | 0.750-1500-36 | 0.750-1500-36-U | 11.490 |
| 3/4" | 1-3/4" | 0.750-1750-12 | 0.750-1750-12-U | 4.460 | 0.750-1750-36 | 0.750-1750-36-U | 13.401 |
| 7/8" | 1" | 0.875-1000-12 | 0.875-1000-12-U | 2.980 | 0.875-1000-36 | 0.875-1000-36-U | 8.94 |
| 7/8" | 1-1/8" | 0.875-1125-12 | 0.875-1125-12-U | 3.350 | 0.875-1125-36 | 0.875-1125-36-U | 10.050 |
| 7/8" | 1-1/4" | 0.875-1250-12 | 0.875-1250-12-U | 3.720 | 0.875-1250-36 | 0.875-1250-36-U | 11.160 |
| 1" | 1-1/8" | 1.000-1125-12 | 1.000-1125-12-U | 3.830 | 1.000-1125-36 | 1.000-1125-36-U | 11.490 |
| 1" | 1-1/4" | 1.000-1250-12 | 1.000-1250-12-U | 4.250 | 1.000-1250-36 | 1.000-1250-36-U | 12.750 |
| 1" | 1-1/2" | 1.000-1500-12 | 1.000-1500-12-U | 5.100 | 1.000-1500-36 | 1.000-1500-36-U | 15.300 |
| 1" | 1-3/4" | 1.000-1.750-12 | 1.000-1.750-12-U | 5.950 | 1.000-1.750-36 | 1.000-1.750-36-U | 17.850 |
| 1" | 2" | 1.000-2000-12 | 1.000-2000-12-U | 6.804 | 1.000-2000-36 | 1.000-2000-36-U | 20.412 |
| 1-1/8" | 1-1/4" | 1.125-1250-12 | 1.125-1250-12-U | 4.780 | 1.125-1250-36 | 1.125-1250-36-U | 14.340 |
| 1-1/4" | 1-3/8" | 1.250-1375-12 | 1.250-1375-12-U | 5.840 | 1.250-1375-36 | 1.250-1375-36-U | 17.520 |
| 1-1/4" | 1-1/2" | 1.250-1500-12 | 1.250-1500-12-U | 6.380 | 1.250-1500-36 | 1.250-1500-36-U | 19.140 |
| 1-1/4" | 1-3/4" | 1.250-1750-12 | 1.250-1750-12-U | 7.440 | 1.250-1750-36 | 1.250-1750-36-U | 22.320 |
| 1-1/2" | 1-3/4" | 1.500-1750-12 | 1.500-1750-12-U | 8.980 | 1.500-1750-36 | 1.500-1750-36-U | 26.940 |
| 1-1/2" | 2" | 1.500-2000-12 | 1.500-2000-12-U | 10.200 | 1.500-2000-36 | 1.500-2000-36-U | 30.600 |
| 1-3/4" | 2-1/2" | 1.750-2500-12 | 1.750-2500-12-U | 14.89 | 1.750-2500-36 | 1.750-2500-36-U | 44.670 |
| 2" | 2-1/2" | 2.000-2500-12 | 2.000-2500-12-U | 17.33 | 2.000-2500-36 | 2.000-2500-36-U | 52.000 |

DMR™ undersize keystone is used where close or undersized tolerances are required. Made from 1018 steel and 303 stainless steel.

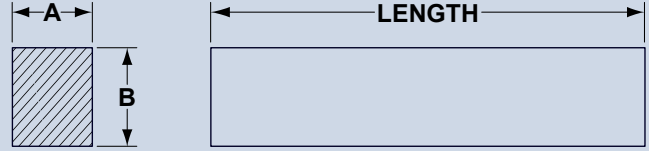

TOLERANCES

| 1018 STEEL | | | 303 STAINLESS | | |
|-------------------|--------------------|--------------------|---------------|--------------------|--------------------|
| SIZE | UNPLATED | ZINC PLATED | SIZE | SQUARES | FLATS |
| 3/4" and smaller | + .000 to -.003 | + .001 to -.002 | 1/8" – 1/4" | + .000 to -.002 | + .004 to -.004 |
| 3/4" – 1 -1/2" | + .000 to -.004 | + .001 to -.003 | 5/16" – 7/16" | + .000 to -.003 | + .002 to -.002 |
| Over 1-1/2" | + .000 to -.005 | + .001 to -.004 | 1/2" 7/8" | + .000 to -.004 | + .002 to -.002 |
| – | – | – | 1" | + .000 to -.006 | – |

| SIZES | | | DMR PART # | | |
|-------|-------|--------|---------------|--------------|-------------------|
| A | B | LENGTH | ZINC PLATED | UNPLATED | WEIGHT PER 12" |
| 1/8" | 1/8" | 12 | U-0.125-12 | U-.125-12-U | 0.05 |
| 1/8" | 3/16" | 12 | U-.125-188-12 | U-.125-188-U | 0.08 |
| 3/16" | 3/16" | 12 | U-0.188-12 | U-.188-12-U | 0.12 |
| 1/8" | 1/4" | 12 | U-.125-250-12 | U-.125-250-U | 0.11 |
| 3/16" | 1/4" | 12 | U-.188-250-12 | U-.188-250-U | 0.16 |
| 1/4" | 1/4" | 12 | U-0.250-12 | U-.250-12-U | 0.21 |
| 3/16" | 5/16" | 12 | U-.188-312-12 | U-.188-312-U | 0.20 |
| 1/4" | 5/16" | 12 | U-.250-312-12 | U-.250-312-U | 0.27 |

| SIZES | | | DMR PART # | | |
|--------|--------|--------|----------------|---------------|----------------|
| A | B | LENGTH | ZINC PLATED | UNPLATED | WEIGHT PER 12" |
| 3/16" | 3/8" | 12 | U-0.188-375-12 | U-0.188-375-U | 0.24 |
| 1/4" | 3/8" | 12 | U-0.250-375-12 | U-0.250-375-U | 0.32 |
| 5/16" | 3/8" | 12 | U-0.313-375-12 | U-0.313-375-U | 0.40 |
| 3/8" | 3/8" | 12 | U-0.375-12 | U-0.375-12-U | 0.48 |
| 1/4" | 7/16" | 12 | U-0.250-438-12 | U-0.250-438-U | 0.37 |
| 5/16" | 7/16" | 12 | U-0.313-438-12 | U-0.313-438-U | 0.46 |
| 3/8" | 7/16" | 12 | U-0.375-438-12 | U-0.375-438-U | 0.59 |
| 7/16" | 7/16" | 12 | U-0.438-12 | U-0.438-12-U | 0.65 |
| 1/4" | 1/2" | 12 | U-0.250-500-12 | U-0.250-500-U | 0.42 |
| 5/16" | 1/2" | 12 | U-0.313-500-12 | U-0.313-500-U | 0.53 |
| 3/8" | 1/2" | 12 | U-0.375-500-12 | U-0.375-500-U | 0.64 |
| 7/16" | 1/2" | 12 | U-0.438-500-12 | U-0.438-500-U | 0.74 |
| 1/2" | 1/2" | 12 | U-0.500-12 | U-0.500-12-U | 0.85 |
| 9/16" | 9/16" | 12 | U-0.563-12 | U-0.563-12-U | 1.08 |
| 5/16" | 5/8" | 12 | U-0.313-625-12 | U-0.313-625-U | 0.66 |
| 3/8" | 5/8" | 12 | U-0.375-625-12 | U-0.375-625-U | 0.80 |
| 1/2" | 5/8" | 12 | U-0.500-625-12 | U-0.500-625-U | 1.06 |
| 5/8" | 5/8" | 12 | U-0.625-12 | U-0.625-12-U | 1.33 |
| 3/4" | 3/4" | 12 | U-0.750-12 | U-0.750-12-U | 1.91 |
| 7/8" | 7/8" | 12 | U-0.875-12 | U-0.875-12-U | 2.60 |
| 1" | 1" | 12 | U-1.000-12 | U-1.000-12-U | 3.40 |
| 1-1/8" | 1-1/8" | 12 | U-1.125-12 | U-1.125-12-U | 4.30 |
| 1-1/4" | 1-1/4" | 12 | U-1.250-12 | U-1.250-12-U | 5.31 |
| 1-3/8" | 1-3/8" | 12 | U-1.375-12 | U-1.375-12-U | 6.43 |
| 1-1/2" | 1-1/2" | 12 | U-1.500-12 | U-1.500-12-U | 7.65 |
| 1-3/4" | 1-3/4" | 12 | U-1.750-12 | U-1.750-12-U | 10.41 |
| 2" | 2" | 12 | U-2.000-12 | U-2.000-12-U | 13.60 |

DMR™ Metric Key Stock is made of the highest quality zinc plated cold drawn steel. Bars are cut – not sheared. Material 1018. Oversize tolerances: -.000 to + .0762mm. Sold in 12 inch and 1 meter (40 inch lengths.)

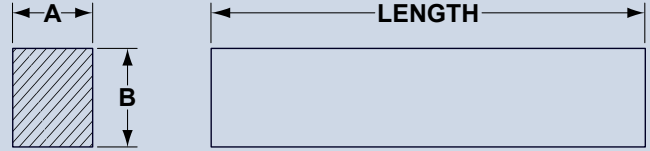

| DMR™ PART # (12" LENGTH) | METRIC (MM) | | INCH (") | | WEIGHT PER PIECE | DMR™ PART # (1 METRE LENGTH) |
|-----------------------------|----------------|----|-------------|-------|---------------------|------------------------------------|
| | A | B | A | B | | |
| 4MM-12 | 4 | 4 | .1575 | .1575 | 0.080 | 4MM-1M |
| 5MM-12 | 5 | 5 | .1969 | .1969 | 0.170 | 5MM-1M |
| 5-8MM-12 | 5 | 8 | .1969 | .3150 | 0.234 | 5-8MM-1M |
| 6MM-12 | 6 | 6 | .2362 | .2362 | 0.187 | 6MM-1M |
| 6-10MM-12 | 6 | 10 | .2362 | .3937 | 0.206 | 6-10MM-1M |
| 6-12MM-12 | 6 | 12 | .2362 | .4724 | 0.381 | 6-12MM-1M |
| 6-14MM-12 | 6 | 14 | .2362 | .5512 | 0.446 | 6-14MM-1M |
| 7MM-12 | 7 | 7 | .2756 | .2756 | 0.274 | 7MM-1M |
| 7-8MM-12 | 7 | 8 | .2756 | .3150 | 0.313 | 7-8MM-1M |
| 7-16MM-12 | 7 | 16 | .2756 | .6299 | 0.609 | 7-16MM-1M |
| 7-18MM-12 | 7 | 18 | .2756 | .7087 | 0.688 | 7-18MM-1M |
| 8MM-12 | 8 | 8 | .3150 | .3150 | 0.350 | 8MM-1M |
| 8-10MM-12 | 8 | 10 | .3150 | .3937 | 0.438 | 8-10MM-1M |
| 8-12MM-12 | 8 | 12 | .3150 | .4724 | 0.530 | 8-12MM-1M |
| 8-20MM-12 | 8 | 20 | .3150 | .7874 | 0.863 | 8-20MM-1M |
| 9-14MM-12 | 9 | 14 | .3543 | .5512 | 0.688 | 9-14MM-1M |
| 9-22MM-12 | 9 | 22 | .3543 | .8661 | 1.109 | 9-22MM-1M |
| 10MM-12 | 10 | 10 | .3937 | .3937 | 0.531 | 10MM-1M |
| 10-12MM-12 | 10 | 12 | .3937 | .4724 | 0.662 | 10-12MM-1M |
| 10-16MM-12 | 10 | 16 | .3937 | .6299 | 0.875 | 10-16MM-1M |
| 11-18MM-12 | 11 | 18 | .4331 | .7087 | 1.063 | 11-18MM-1M |

| DMR™ PART # (12" LENGTH) | METRIC (MM) | | INCH (") | | WEIGHT PER PIECE | DMR™ PART # (1 METRE LENGTH) |
|-----------------------------|----------------|----|-------------|--------|---------------------|---------------------------------------|
| | A | B | A | B | | |
| 12MM-12 | 12 | 12 | .4724 | .4724 | 0.781 | 12MM-1M |
| 12-20MM-12 | 12 | 20 | .4724 | .7874 | 1.281 | 12-20MM-1M |
| 14MM-12 | 14 | 14 | .5512 | .5512 | 1.047 | 14MM-1M |
| 14-22MM-12 | 14 | 22 | .5512 | .8661 | 1.641 | 14-22MM-1M |
| 16MM-12 | 16 | 16 | .6299 | .6299 | 1.375 | 16MM-1M |
| 16-28MM-12 | 16 | 28 | .6299 | 1.1024 | 2.375 | 16-28MM-1M |
| 18MM-12 | 18 | 18 | .7087 | .7087 | 1.734 | 18MM-1M |
| 18-32MM-12 | 18 | 32 | .7087 | 1.2600 | 3.094 | 18-32MM-1M |
| 20MM-12 | 20 | 20 | .7874 | .7874 | 2.125 | 20MM-1M |
| 20-36MM | 20 | 36 | .7874 | 1.4173 | 3.813 | 20-36MM |
| 22MM-12 | 22 | 22 | .8661 | .8661 | 2.596 | 22MM-1M |
| 22-25MM-12 | 22 | 25 | .8661 | .9843 | 2.925 | 22-25MM-1M |
| 22-40MM-12 | 22 | 40 | .8661 | 1.5748 | 4.641 | 22-40MM-1M |
| 25MM-12 | 25 | 25 | .9843 | .9843 | 3.28 | 25MM-1M |
| 25-28MM-12 | 25 | 28 | .9843 | 1.1024 | 3.692 | 25-28MM-1M |

DMR™ STEP KEYSTOCK

Cold finished. Oversize keystone ground down to A, B-D & C dimensions per tolerances listed below. Use for couplings, gears, sheaves, sprockets, pulleys – anything that keys to a shaft. Available in 12 inch lengths. Material is 1018 carbon steel, zinc plated for corrosion resistance.

Tolerances: Type 1

| | |
|------------------|---------------|
| A & C dimensions | -0.000/+0.002 |
| B/D dimensions | -0.003/+0.003 |
| B & D dimensions | -0.004/+0.004 |

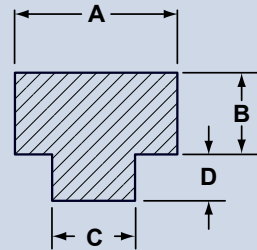

TYPE 1

Tolerances: Type 2

| | |
|------------------|---------------|
| C & A dimensions | -0.000/+0.002 |
| B/D dimensions | -0.005/+0.005 |
| B & D dimensions | -0.005/+0.005 |

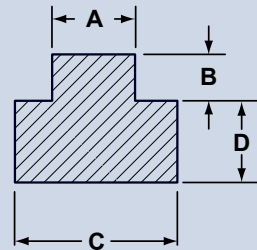

TYPE 2

Physical & Mechanical Properties

| | | |
|--|--|--|
| Tensile Strength (psi): 75,000 - 80,000 | Elongation in 2": 18-25% | Brinell Hardness Range: 150-155 |
| Yield Strength (psi): 60,000 - 70,000 | Reduction of Area in 2": 50-55% | Rockwell B Hardness: 82 |

| DMR™ PART # | TYPE | A | B | C | D | WEIGHT PER PIECE |
|-------------|------|-------|-------|--------|-------|------------------|
| SK-1-1 | 1 | 3/16" | 3/32" | 1/8" | 1/16" | 0.088 |
| SK-2-2 | 2 | 3/16" | 3/32" | 1/4" | 3/32" | 0.141 |
| SK-3-2 | 2 | 3/16" | 3/32" | 1/4" | 1/8" | 0.166 |
| SK-4-2 | 2 | 1/4" | 1/8" | 5/16" | 1/8" | 0.241 |
| SK-5-2 | 2 | 1/4" | 1/8" | 3/8" | 1/8" | 0.269 |
| SK-6-2 | 2 | 1/4" | 1/8" | 3/8" | 3/16" | 0.347 |
| SK-7-1 | 1 | 3/8" | 3/16" | 5/16" | 1/8" | 0.375 |
| SK-8-1 | 1 | 3/8" | 3/16" | 5/16" | 5/32" | 0.406 |
| SK-9-2 | 2 | 3/8" | 3/16" | 7/16" | 5/32" | 0.475 |
| SK-10-2 | 2 | 3/8" | 3/16" | 1/2" | 3/16" | 0.562 |
| SK-11-2 | 2 | 3/8" | 3/16" | 1/2" | 1/4" | 0.68 |
| SK-12-1 | 1 | 1/2" | 1/4" | 7/16" | 5/32" | 0.663 |
| SK-13-2 | 2 | 1/2" | 1/4" | 9/16" | 3/16" | 0.788 |
| SK-14-2 | 2 | 1/2" | 1/4" | 5/8" | 3/16" | 0.827 |
| SK-15-2 | 2 | 1/2" | 1/4" | 5/8" | 5/16" | 1.09 |
| SK-16-2 | 2 | 1/2" | 1/4" | 11/16" | 1/4" | 1.01 |
| SK-17-1 | 1 | 5/8" | 5/16" | 3/8" | 3/16" | 0.906 |
| SK-18-2 | 2 | 5/8" | 5/16" | 11/16" | 1/4" | 1.25 |
| SK-19-1 | 1 | 3/4" | 3/8" | 1/2" | 1/4" | 1.39 |
| SK-20-1 | 1 | 3/4" | 3/8" | 5/8" | 3/16" | 1.36 |
| SK-21-1 | 1 | 3/4" | 3/8" | 5/8" | 5/16" | 1.64 |
| SK-22-1 | 1 | 3/4" | 3/8" | 11/16" | 1/4" | 1.54 |
| SK-23-2 | 2 | 3/4" | 3/8" | 13/16" | 9/32" | 1.74 |
| SK-24-2 | 2 | 3/4" | 3/8" | 7/8" | 7/16" | 2.28 |
| SK-25-2 | 2 | 3/4" | 3/8" | 15/16" | 5/16" | 1.97 |
| SK-26-2 | 2 | 3/4" | 3/8" | 1" | 1/2" | 2.66 |
| SK-27-1 | 1 | 1" | 1/2" | 7/8" | 7/16" | 3.02 |

| | |
|--------------------|--|
| DMR™ Part # | Material |
| SZC-1 | Steel shipping weight: 10.3lbs |
| SZC-S | Stainless shipping weight: 10.4lbs |
| SZC-B | Brass shipping weight: 11.3lbs |

| SIZE 12" LENGTH | # OF BARS |
|-----------------|-----------|
| 1/8" Square | 5 |
| 3/16" Square | 5 |
| 1/4" Square | 5 |
| 5/16" Square | 5 |
| 3/8" Square | 5 |
| 7/16" Square | 3 |
| 1/2" Square | 3 |
| Total | 31 |

| | |
|--------------------|--|
| DMR™ Part # | |
| MK-7-305 | Metric shipping weight: 9.3lbs |

| SIZE 12" LENGTH | # OF BARS |
|-----------------|-----------|
| 4 MM | 5 pcs |
| 5MM | 5 pcs |
| 6MM | 5 pcs |
| 7MM | 5 pcs |
| 8MM | 5 pcs |
| 10MM | 3 pcs |
| 12MM | 3 pcs |
| Total | 31 |

DMR 3 foot unplated round steel shafts are made from bar-quality cold drawn steel – 50% stronger than hot-rolled mild steel – which can be drilled and have keyways cut. Just right for furnace blower shafts, ventilator shafts, axles, farm equipment drive shafts and many uses you will discover yourself. Each shaft has a cold-drawn finish for use with brass, bronze copper or aluminum bushings. Bar ends are machine-cut, not sheared. Tolerances will run plus .000" to minus .002"

Material: 1018 carbon steel Finish: Unplated Tolerance: +.000" to -.002"

| DMR # | DIAMETER | WEIGHT OF BUNDLE |
|--------------|----------|------------------|
| 0.125-36-RND | 1/8" | 0.38 |
| 0.188-36-RND | 3/16" | 0.85 |
| 0.250-36-RND | 1/4" | 1.50 |
| 0.313-36-RND | 5/16" | 2.34 |
| 0.375-36-RND | 3/8" | 3.38 |
| 0.438-36-RND | 7/16" | 4.60 |
| 0.500-36-RND | 1/2" | 6.00 |
| 0.563-36-RND | 9/16" | 7.62 |
| 0.625-36-RND | 5/8" | 9.39 |
| 0.750-36-RND | 3/4" | 13.50 |
| 0.875-36-RND | 7/8" | 18.42 |
| 0.938-36-RND | 15/16" | 21.00 |
| 1.000-36-RND | 1" | 24.00 |
| 1.125-36-RND | 1-1/8" | 30.42 |
| 1.188-36-RND | 1-3/16" | 34.11 |
| 1.250-36-RND | 1-1/4" | 37.50 |
| 1.375-36-RND | 1-3/8" | 46.11 |
| 1.438-36-RND | 1-7/16" | 49.50 |
| 1.500-36-RND | 1-1/2" | 54.00 |

Machined from 1035 steel, DMR™ Keys (Half Moon Keys) are available from stock in 50 S.A.E. standard sizes. Special sizes and materials such as alloy steel (A-8630) are available on special order from the factory. Assortments of popular sizes are available for the convenience of mechanics and repair personnel.

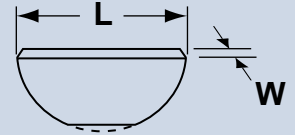

| DMR # | W | L | USA STD. NO. | WEIGHT PER 100 |
|--------|-------|--------|--------------|----------------|
| WK-201 | 1/16" | 1/4" | 202 | 0.04 |
| WK-207 | 3/32" | 5/16" | 302.5 | 0.09 |
| WK-211 | 1/16" | 3/8" | 203 | 0.09 |
| WK-212 | 3/32" | 3/8" | 303 | 0.13 |
| WK-213 | 1/8" | 3/8" | 403 | 0.15 |
| WK-01 | 1/16" | 1/2" | 204 | 0.13 |
| WK-02 | 3/32" | 1/2" | 304 | 0.19 |
| WK-03 | 1/8" | 1/2" | 404 | 0.25 |
| WK-04 | 3/32" | 5/8" | 305 | 0.3 |
| WK-05 | 1/8" | 5/8" | 405 | 0.39 |
| WK-06 | 5/32" | 5/8" | 505 | 0.49 |
| WK-61 | 3/16" | 5/8" | 605 | 0.58 |
| WK-07 | 1/8" | 3/4" | 406 | 0.61 |
| WK-08 | 5/32" | 3/4" | 506 | 0.75 |
| WK-09 | 3/16" | 3/4" | 606 | 0.9 |
| WK-91 | 1/4" | 3/4" | 806 | 1.2 |
| WK-10 | 5/32" | 7/8" | 507 | 1.1 |
| WK-11 | 3/16" | 7/8" | 607 | 1.3 |
| WK-12 | 7/32" | 7/8" | 707 | 1.5 |
| WK-A | 1/4" | 7/8" | 807 | 1.7 |
| WK-141 | 1/4" | 15/16" | - | 2 |
| WK-13 | 3/16" | 1" | 608 | 1.7 |
| WK-14 | 7/32" | 1" | 708 | 2 |

| DMR # | W | L | USA STD. NO. | WEIGHT PER 100 |
|--------------|----------|----------|---------------------|-----------------------|
| WK-15 | 1/4" | 1" | 808 | 2.3 |
| WK-B | 5/16" | 1" | 1008 | 2.9 |
| WK-152 | 3/8" | 1" | 1208 | 3.6 |
| WK-16 | 3/16" | 1-1/8" | 609 | 2.2 |
| WK-17 | 7/32" | 1-1/8" | 709 | 2.5 |
| WK-18 | 1/4" | 1-1/8" | 809 | 2.9 |
| WK-C | 5/16" | 1-1/8" | 1009 | 3.6 |
| WK-19 | 3/16" | 1-1/4" | 610 | 2.7 |
| WK-20 | 7/32" | 1-1/4" | 710 | 3.2 |
| WK-21 | 1/4" | 1-1/4" | 810 | 3.6 |
| WK-D | 5/16" | 1-1/4" | 1010 | 4.5 |
| WK-E | 3/8" | 1-1/4" | 1210 | 5.4 |
| WK-22 | 1/4" | 1-3/8" | 811 | 4.3 |
| WK-23 | 5/16" | 1-3/8" | 1011 | 5.4 |
| WK-F | 3/8" | 1-3/8" | 1211 | 6.5 |
| WK-245 | 1/4" | 1-1/2" | 812 | 5 |
| WK-25 | 5/16" | 1-1/2" | 1012 | 6.3 |
| WK-G | 3/8" | 1-1/2" | 1212 | 7.5 |
| WK-126 | 3/16" | 2-1/8" | 617-1 | 2.3 |
| WK-127 | 1/4" | 2-1/8" | 817-1 | 3.1 |
| WK-128 | 5/16" | 2-1/8" | 1017-1 | 3.9 |
| WK-129 | 3/8" | 2-1/8" | 1217-1 | 4.7 |
| WK-26 | 3/16" | 2-1/8" | 617 | 3.6 |
| WK-27 | 1/4" | 2-1/8" | 817 | 4.8 |
| WK-28 | 5/16" | 2-1/8" | 1017 | 6 |
| WK-29 | 3/8" | 2-1/8" | 1217 | 7.2 |
| WK-RX | 1/4" | 2-3/4" | 822-1 | 6.4 |
| WK-SX | 5/16" | 2-3/4" | 1022 | 7.99 |
| WK-TX | 3/8" | 2-3/4" | 1222-1 | 9.6 |
| WK-VX | 1/2" | 2-3/4" | 1622-1 | 12.9 |

DMR™ WOODRUFF KEY ASSORTMENT NO. 1

(WK #1 Assort) Packaged in a compartmented plastic box.

- Machined from 1035 Steel
- Standard SAE Sizes
- Contains 90 Keys

| DMR # | NO. | QUANTITY | DMR # | NO. | QUANTITY | DMR # | NO. | QUANTITY |
|-------|-----|----------|-------|-----|----------|-------|-----|----------|
| WK-01 | 1 | 5 | WK-08 | 8 | 5 | WK-15 | 15 | 5 |
| WK-02 | 2 | 5 | WK-09 | 9 | 5 | WK-16 | 16 | 5 |
| WK-03 | 3 | 5 | WK-10 | 10 | 5 | WK-18 | 18 | 5 |
| WK-04 | 4 | 5 | WK-11 | 11 | 5 | WK-A | A | 5 |
| WK-05 | 5 | 5 | WK-13 | 13 | 5 | WK-B | B | 5 |
| WK-06 | 6 | 5 | WK-14 | 14 | 5 | WK-C | C | 5 |
| WK-07 | 7 | 5 | | | | | | |

DMR™ WOODRUFF KEY ASSORTMENT NO. 2

(WK #2 Assort)

- Machined from 1035 Steel
- Standard SAE Sizes
- Contains 204 Keys

| DMR # | NO. | QUANTITY | DMR # | NO. | QUANTITY | DMR # | NO. | QUANTITY |
|--------|-----|----------|-------|-----|----------|--------|-----|----------|
| WK-03 | 3 | 30 | WK-16 | 16 | 6 | WK-D | D | 6 |
| WK-211 | 211 | 30 | WK-21 | 21 | 6 | WK-E | E | 4 |
| WK-212 | 212 | 30 | WK-24 | 24 | 4 | WK-F | F | 4 |
| WK-213 | 213 | 30 | WK-25 | 25 | 4 | WK-126 | 126 | 6 |
| WK-61 | 61 | 16 | WK-28 | 28 | 3 | WK-127 | 127 | 6 |
| WK-91 | 91 | 10 | WK-29 | 29 | 3 | WK-128 | 128 | 6 |

DMR™ gib head keys are used for holding pulleys and gears tightly on the shaft. They are tapered $1/8''$ per foot to fit snugly on the shaft and are machined from 1018 steel.

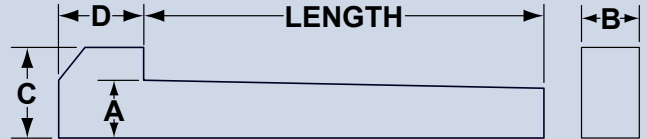

| DMR # | A | B | LENGTH | C | D | WEIGHT PER 100 |
|-----------|------|------|--------|-----|------|----------------|
| 0.250-1 | 1/4 | 1/4 | 1 | 1/2 | 3/8 | 3 |
| 0.250-1.5 | 1/4 | 1/4 | 1-1/2 | 1/2 | 3/8 | 3.9 |
| 0.250-2 | 1/4 | 1/4 | 2 | 1/2 | 3/8 | 4.7 |
| 0.250-2.5 | 1/4 | 1/4 | 2-1/2 | 1/2 | 3/8 | 5.4 |
| 0.250-3 | 1/4 | 1/4 | 3 | 1/2 | 3/8 | 6.2 |
| 0.313-1 | 5/16 | 5/16 | 1 | 1/2 | 7/16 | 4.6 |
| 0.313-1.5 | 5/16 | 5/16 | 1-1/2 | 1/2 | 7/16 | 5.8 |
| 0.313-2 | 5/16 | 5/16 | 2 | 1/2 | 7/16 | 7.3 |
| 0.313-2.5 | 5/16 | 5/16 | 2-1/2 | 1/2 | 7/16 | 8.5 |
| 0.313-3 | 5/16 | 5/16 | 3 | 1/2 | 7/16 | 9.8 |
| 0.375-1 | 3/8 | 3/8 | 1 | 5/8 | 1/2 | 7.3 |
| 0.375-1.5 | 3/8 | 3/8 | 1-1/2 | 5/8 | 1/2 | 9.1 |
| 0.375-2 | 3/8 | 3/8 | 2 | 5/8 | 1/2 | 10.9 |
| 0.375-2.5 | 3/8 | 3/8 | 2-1/2 | 5/8 | 1/2 | 12.9 |
| 0.375-3 | 3/8 | 3/8 | 3 | 5/8 | 1/2 | 14.7 |
| 0.375-3.5 | 3/8 | 3/8 | 3-1/2 | 5/8 | 1/2 | 16.5 |
| 0.375-4 | 3/8 | 3/8 | 4 | 5/8 | 1/2 | 17.9 |
| 0.500-1 | 1/2 | 1/2 | 1 | 3/4 | 5/8 | 13.5 |

| DMR # | A | B | LENGTH | C | D | WEIGHT PER 100 |
|--------------|----------|----------|---------------|----------|----------|-----------------------|
| 0.500-1.5 | 1/2 | 1/2 | 1-1/2 | 3/4 | 5/8 | 16.9 |
| 0.500-2 | 1/2 | 1/2 | 2 | 3/4 | 5/8 | 20.3 |
| 0.500-2.5 | 1/2 | 1/2 | 2-1/2 | 3/4 | 5/8 | 23.7 |
| 0.500-3 | 1/2 | 1/2 | 3 | 3/4 | 5/8 | 27.2 |
| 0.500-3.5 | 1/2 | 1/2 | 3-1/2 | 3/4 | 5/8 | 30.6 |
| 0.500-4 | 1/2 | 1/2 | 4 | 3/4 | 5/8 | 33 |
| 0.500-6 | 1/2 | 1/2 | 6 | 3/4 | 5/8 | 46.7 |
| 0.625-4 | 5/8 | 5/8 | 4 | 1 | 3/4 | 55.9 |
| 0.625-6 | 5/8 | 5/8 | 6 | 1 | 3/4 | 75.3 |
| 0.750-5 | 3/4 | 3/4 | 5 | 1-1/8 | 7/8 | 97.6 |
| 0.750-6 | 3/4 | 3/4 | 6 | 1-1/8 | 7/8 | 110 |
| 0.875-6 | 7/8 | 7/8 | 6 | 1-1/4 | 1 | 156 |
| 1.000-6 | 1 | 1 | 6 | 1-1/2 | 1-1/8 | 211 |

- Manufactured from 1018 carbon steel
- Plain or zinc plated finish
- End styles available: both ends square, one end round, both ends round

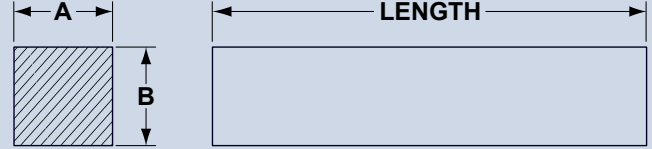

| DMR # | A | B | LENGTH | WEIGHT PER 100 |
|--------------|------|------|--------|----------------|
| .125X0.500SQ | 1/8 | 1/8 | 1/2 | 0.21 |
| .125X0.750SQ | 1/8 | 1/8 | 3/4 | 0.32 |
| .125X1.000SQ | 1/8 | 1/8 | 1 | 0.42 |
| .125X1.250SQ | 1/8 | 1/8 | 1-1/4 | 0.52 |
| .125X1.500SQ | 1/8 | 1/8 | 1-1/2 | 0.63 |
| .188X0.500SQ | 3/16 | 3/16 | 1/2 | 0.5 |
| .188X0.750SQ | 3/16 | 3/16 | 3/4 | 0.75 |
| .188X1.000SQ | 3/16 | 3/16 | 1 | 1 |
| .188X1.250SQ | 3/16 | 3/16 | 1-1/4 | 1.25 |
| .188X1.500SQ | 3/16 | 3/16 | 1-1/2 | 1.5 |
| .188X1.750SQ | 3/16 | 3/16 | 1-3/4 | 1.75 |
| .188X2.000SQ | 3/16 | 3/16 | 2 | 2 |
| .188X2.250SQ | 3/16 | 3/16 | 2-1/4 | 2.25 |
| .188X2.500SQ | 3/16 | 3/16 | 2-1/2 | 2.5 |
| .250X0.500SQ | 1/4 | 1/4 | 1/2 | 0.88 |
| .250X1.000SQ | 1/4 | 1/4 | 1 | 1.74 |
| .250X1.250SQ | 1/4 | 1/4 | 1-1/4 | 2.18 |
| .250X1.500SQ | 1/4 | 1/4 | 1-1/2 | 2.63 |
| .250X2.000SQ | 1/4 | 1/4 | 2 | 3.51 |
| .250X2.250SQ | 1/4 | 1/4 | 2-1/4 | 3.95 |

| DMR # | A | B | LENGTH | WEIGHT PER 100 |
|--------------|----------|----------|---------------|-----------------------|
| .250X2.500SQ | 1/4 | 1/4 | 2-1/2 | 4.37 |
| .313X0.750SQ | 5/16 | 5/16 | 3/4 | 2.08 |
| .313X1.000SQ | 5/16 | 5/16 | 1 | 2.74 |
| .313X1.250SQ | 5/16 | 5/16 | 1-1/4 | 3.43 |
| .313X1.500SQ | 5/16 | 5/16 | 1-1/2 | 4.13 |
| .313X1.750SQ | 5/16 | 5/16 | 1-3/4 | 4.82 |
| .313X2.000SQ | 5/16 | 5/16 | 2 | 5.51 |
| .313X2.250SQ | 5/16 | 5/16 | 2-1/4 | 6.2 |
| .313X2.500SQ | 5/16 | 5/16 | 2-1/2 | 6.86 |
| .375X1.000SQ | 3/8 | 3/8 | 1 | 3.98 |
| .375X1.250SQ | 3/8 | 3/8 | 1-1/4 | 4.99 |
| .375X1.500SQ | 3/8 | 3/8 | 1-1/2 | 6 |
| .375X1.750SQ | 3/8 | 3/8 | 1-3/4 | 7.01 |
| .375X2.000SQ | 3/8 | 3/8 | 2 | 8.02 |
| .375X2.250SQ | 3/8 | 3/8 | 2-1/4 | 9.02 |
| .375X2.500SQ | 3/8 | 3/8 | 2-1/2 | 9.98 |
| .375X2.750SQ | 3/8 | 3/8 | 2-3/4 | 10.99 |
| .375X3.000SQ | 3/8 | 3/8 | 3 | 12 |
| .500X1.000SQ | 1/2 | 1/2 | 1 | 7.06 |
| .500X1.250SQ | 1/2 | 1/2 | 1-1/4 | 8.84 |
| .500X1.500SQ | 1/2 | 1/2 | 1-1/2 | 10.63 |
| .500X2.000SQ | 1/2 | 1/2 | 2 | 14.2 |
| .500X2.500SQ | 1/2 | 1/2 | 2-1/2 | 17.68 |
| .500X2.750SQ | 1/2 | 1/2 | 2-3/4 | 19.47 |
| .500X3.000SQ | 1/2 | 1/2 | 3 | 21.25 |

DMR Kit #: SP1

| DMR # | QUANTITY | DIAMETER | LENGTH |
|--------------|-----------------|-----------------|---------------|
| SP-062-0250 | 10 | 1/16" | 1/4" |
| SP-062-0500 | 10 | 1/16" | 1/2" |
| SP-062-0750 | 10 | 1/16" | 3/4" |
| SP-078-0250 | 10 | 5/64" | 1/4" |
| SP-078-0500 | 10 | 5/64" | 1/2" |
| SP-078-0750 | 10 | 5/64" | 3/4" |
| SP-094-0625 | 10 | 3/32" | 5/8" |
| SP-094-1000 | 10 | 3/32" | 1" |
| SP-094-1500 | 10 | 3/32" | 1-1/2" |
| SP-125-0625 | 10 | 1/8" | 5/8" |
| SP-125-1000 | 10 | 1/8" | 1" |
| SP-125-1500 | 10 | 1/8" | 1-1/2" |

DMR Kit #: SP2

| DMR # | QUANTITY | DIAMETER | LENGTH |
|--------------|-----------------|-----------------|---------------|
| SP-156-1000 | 10 | 5/32" | 1" |
| SP-156-1500 | 10 | 5/32" | 1-1/2" |
| SP-187-1000 | 10 | 3/16" | 1" |
| SP-187-1500 | 10 | 3/16" | 1-1/2" |
| SP-219-1500 | 10 | 7/32" | 1-1/2" |
| SP-219-1750 | 10 | 7/32" | 1-3/4" |
| SP-250-1500 | 10 | 1/4" | 1-1/2" |
| SP-250-1750 | 10 | 1/4" | 1-3/4" |
| SP-312-1500 | 10 | 5/16" | 1-1/2" |
| SP-312-1750 | 10 | 5/16" | 1-3/4" |
| SP-375-1500 | 10 | 3/8" | 1-1/2" |
| SP-375-1750 | 10 | 3/8" | 1-3/4" |

SLIDE

SEAL

PROTECT

RETAIN

ALIGN



Dryslide™



Oil Seals



Tapered Caps and Plugs



Rotor Clip®



Woodruff Keys



Fiber-Lube™



O-Ring Kits



Caps

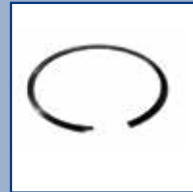

Spirolox®



Slotted Shim



Linear Motion



DMR Bearing Isolators



Plugs

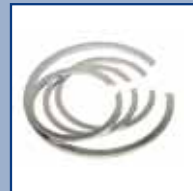

Ring Masters®



Slotted Shim Kits



Powdered Metal



V-Rings



Finishing



Rotor Clamp®

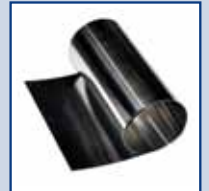

Shim Stock Rolls



Solid Metal



Shaft Repair Sleeves



Electronics



Retaining Ring Kits & Packs



Keystock



DMR™

DAEMAR® INC.

861 CRANBERRY COURT
OAKVILLE, ON L6L 6J7
PH/905/847/6500
FX/905/847/6943
TF/800/387/7115
TFX/800/269/4571
sales@daemarinc.com

DAEMAR® INC.

548 MELOCHE
DORVAL, QC H9P 2T2
PH/514/636/3113
FX/514/633/1206
TF/800/361/6826
mtlsales@daemarinc.com

DAEMAR® INC.

4472-97TH STREET
EDMONTON, AB T6E 5R9
PH/780/435/8899
FX/780/435/9090
TF/800/214/9590
edmsales@daemarinc.com

DAEMAR® INC.

1635 Lakes Parkway, Suite F
Lawrenceville, GA 30043
PH/770/953/4710
FX/770/953/4711
TF/877/432/3627
atlanta@daemarinc.com

www.daemar.com



COH-003